

User's Guide
HITACHI Refrigerator

HITACHI

Inspire the Next

Model

R-V600PWX

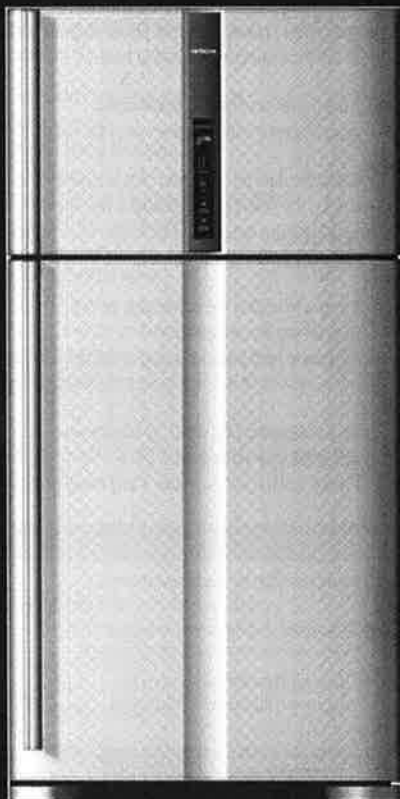

Contents Page

Warning and caution for safety	2
Preparations before use	4
Identification parts	5

Operation

■ Name and function of display	5
Cool Power Display	
■ Temperature control	5
■ Other functions	6
-Quick Freezing	6
-Energy Saving	6
-Child Lock	6
-Door Alarm	6
■ Freezer	
-Automatic Ice maker	7
■ Refrigerator	
-Selectable mode compartment	7

Cleaning	7
Malfunction Display	8
Before requiring repair (calling for service)	8
Service Center	8

Thank you very much for purchasing the HITACHI refrigerator.
Before installation and usage, please read the user's guide carefully
for the correct usage.

R600a
Refrigerant



Warnings and Caution for Safety

The following warnings and cautions are categorized by the level of possible harm or damage that may occur from ignoring directions. And the symbol shown on the right clearly show the significance of directions.

	Warning	This pictograph indicates "There is a high possibility of serious injury or death, if ignored".
	Caution	This pictograph indicates "There is a high possibility of injury or damage to property, if ignored".

The symbols below are examples.	
	This symbol is an alert mark.
	This symbol indicates "prohibited".
	This symbol indicates "necessary".

Warning

This refrigerator contains a small quantity of isobutene refrigerant (R600a), natural gas with high environmental compatibility which is also combustible. Ensure transporting and installing the refrigerator with care. Do not damage any refrigerating circuit.

When you install ... To avoid fire, electric shock, and injury .

- Do not install the refrigerator in a place where it may come in contact with water.
 - This may impair electricity insulation and cause electric shock or fire.
- Ground this refrigerator to prevent electric shock and noise interference. Always ground this refrigerator when using it in places with high humidity or moisture. (Please consult with retailers.)

Power Cord and Power Plug ...To avoid fire, electric shock .

- Do not connect the wall outlet whose power capacity is less than the refrigerator's. Also, do not use power sources that are not a rated voltage.
 - If a power source is shared with other appliances using double or multipoint adapters, the adapter may heat up beyond the normal level and cause fire.
- Do not use the damaged or loose power plug or power outlet. This may cause fire or electric shock.
- Do not cut, bend, fold the power cord to avoid fire and electric shock.
- Do not insert or remove the power plug with wet hands.
- Connect the power plug firmly to a power outlet with the cord running down.
 - Connection of the power plug with the cord running up could apply stress on the cord and cause electrical short or overheat, which could result in electrical shock or fire.
 - Incomplete connection of the power plug could result in electrical shock or fire due to heat.
- If the power cord or plug is damaged, please consult with a retailer about the repair.
- Clean the dust on the power plug frequently with dry cloth.
 - Unplug the power plug and wipe it with dry cloth.
 - An insulation failure due to moisture or when dust sticks on the power plug, may cause fire.
- Be sure to unplug the power plug before maintaining the refrigerator.
 - Be sure to hold the power plug to unplug.

During daily use ...To avoid fire, electric shock .

- Do not splash water on or inside the refrigerator.
 - This may impair electricity insulation causing electric shock or fire.
 - This may also cause gas leakage because of pipe rust.
- Do not use other electrical appliances in the food storage compartment, unless it is the type recommended by the manufacturer.
- This appliance is not intended for use by persons (including children) with reduced physical, sensory or mental capabilities, or lack of experience and knowledge, unless they have been given supervision or instructions concerning use of the appliance by a person responsible for their safety.
- Do not hang on the doors or step up on the various compartments.
 - Injury may be caused by the refrigerator tipping over or hands getting caught in door.
- Do not damage the refrigerant circuit.
 - If you happen to damage the refrigerant tube, stay away from the refrigerator and avoid using fire and electrical appliances.
 - And, open the window to ventilate and contact retailers or service center.
- Do not disassemble, repair, or modify your refrigerator by yourselves.
 - Please consult with a retailer if any repair is required.
- Do not use mechanical devices or any other means to accelerate the defrosting process, other than those recommended by the manufacturer.
- Either liquid propane gas, solvent, etc which is volatile, can not be stored in this refrigerator.
 - Do not put flammable substances in the refrigerator. It may cause explosion or fire.
- Do not put water containers or foreign articles on the top of the refrigerator.
 - Opening and closing doors etc. may cause the articles on the top of the refrigerator falling down, resulting in injury.
- Medicines, chemicals, research and experimental substances should not be stored in the refrigerator.
 - Substances that require precise conditions for storage cannot be stored in a domestic refrigerator.

Warnings and Caution for Safety (Continuance)

Warning

- Do not use the refrigerator in the atmosphere of flammable gas.
- Sparks from points of electrical contacts such as door switches may ignite a fire.



- Children should be supervised to ensure that they do not play with the appliance or get in.
- Children getting inside may not be able to get out.



- In the event of a flammable gas leak, do not touch the refrigerator and open the windows for ventilation.

- Keep ventilation openings in the appliance enclosure or mounting structure clear of obstruction.

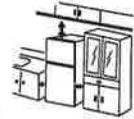

When discarding the refrigerator.

- Follow the instructions of your region when discarding.
- This refrigerator uses R-600a for the refrigerant and cyclopentane for the blowing agent of the urethane heat insulation.

- When discarding the refrigerator, remove the door gaskets.
- To avoid a risk of an infant or child to be entrapped inside.

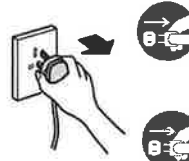

- If you find something wrong with the refrigerator, immediately unplug and consult with the retailers.

- When replacing the refrigerator interior lamp, unplug the power cord. Use the specified lamp and fix it firmly when replacing.

Caution

During daily use ...To avoid illness and injury .

- Do not put bottles, etc. forcibly in the door pockets.
- This may cause bottles dropping down or door pockets coming off.



- Do not store food which smells or food whose color is changed abnormal.
- Such an action may cause diseases.



- Food and containers inside the freezer compartment should not be touched with wet hands.
- This may cause frost injury. (Especially in case of metal items.)



- Do not hold the top, bottom and side of the doors when closing them.
- This may result in your fingers caught by the door edge.



- Be sure to hold the handle firmly to open and close the door.

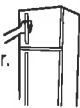

- Do not have food items protruding over the front edge of each shelf.
- Doors may not be closed properly or the door pockets may drop down. Injury may be caused from items like bottles falling and knocking over your feet.



- Do not store glass bottles in the freezer compartment.
- Bottles may break by the contents freezing and cause injury.

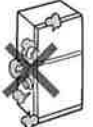

- Do not put your hands into the bottom surface of the refrigerator cabinet.
- When cleaning, putting your hands near the bottom surface of the refrigerator may result in injury by thin metal sheets.



- Do not have your feet too close when opening the door of the refrigerator.
- When opening the door, your feet may be hit, resulting in injury.



When moving or carrying ...To avoid damaging, wetting, soiling the floor, or to avoid injury.

- Excessive weight hazard: four or more people are required when moving and unpacking the refrigerator.
- Unpack all packaging in customer's house.
- Keep the refrigerator in a standing position during transportation.
- Use a trolley to move this refrigerator.

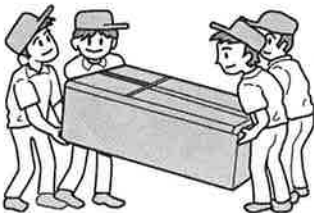

- On a floor that is easily scratched, do not move the refrigerator with the wheels of the refrigerator.
- The wheels may scratch the floor.
- For a floor that may be easily scratched, lay a protective mat, etc. .



- Do not use door handles when carrying the refrigerator.

Preparations before Use

Installation

1. Install on a rigid and level floor.
2. Please use this refrigerator in a room temperature between 10°C to 43°C.
Sufficient performance may not be obtained, if the room temperature is too low or too high.
3. Do not install the refrigerator where it is exposed to direct sunlight or other heat source.
4. Install in an atmosphere which is dry or has air ventilation.
5. The refrigerator requires enough air ventilation space around the cabinet to have efficient cooling performance
Space of at least 30 cm over the top, 10 cm at rear and 5 cm at both sides for proper air circulation.
6. Ground the refrigerator to prevent electric shock and noise interference. Always ground this refrigerator, when using it in places with high humidity or moisture (Please consult with retailers).
7. Make the refrigerator stand horizontally by adjusting the leveling legs (adjustor).
8. Place the front cover in the direction as figure and insert both into the holes until locked position.

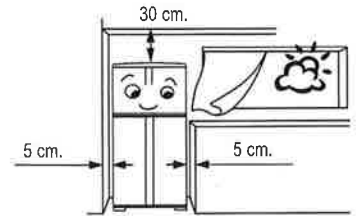
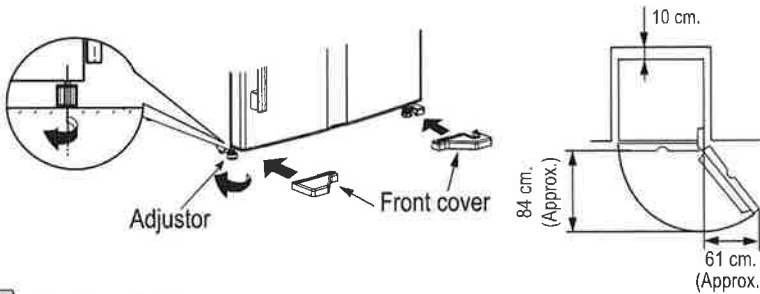
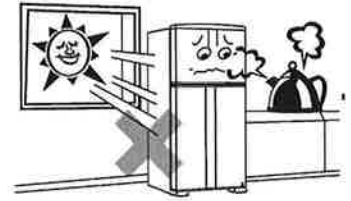

Handle installation

These refrigerator handles are knock down type. Please always read and obey all safety messages.

Caution

1. Be careful when attaching or removing handles to prevent scratching the door.
2. The handle could be damaged if you hit it with a hammer while removing or attaching.

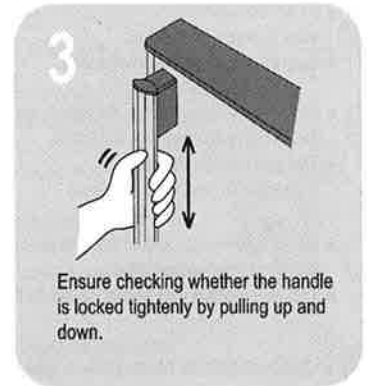
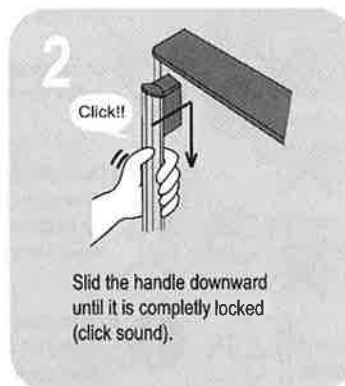
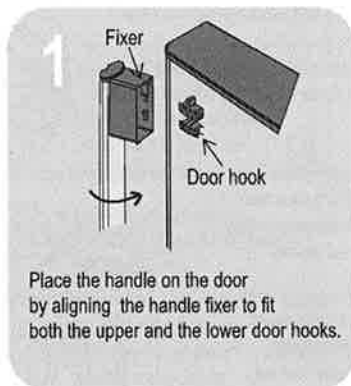

Beginning

1. Clean inside the refrigerator. Wipe the surface gently with soft cloth.
2. Connect the refrigerator to an exclusive wall power outlet. The refrigerator can be connected to an outlet soon after it is installed. Surely use with the rated voltage and exclusive power outlet.
3. Allow enough duration for sufficient cooling before storing food. It may take about 4 hours to fully cool down and could even take about 24 hours when the ambient temperature is high.



Food storage

1. Keep enough space between food. Several food placed too close together may obstruct the flow of cold air.
2. Make food cool enough before putting it in the refrigerator. Putting warm food in the refrigerator raises the inside temperature and wastes electricity.
3. Do not block the cold air vent. This will adversely affect the cold air flow and may not keep the temperature inside even. Moreover, it could result in freezing food near the vent.
4. Using food wrap or sealed containers prevent the food from drying on transition of smells.

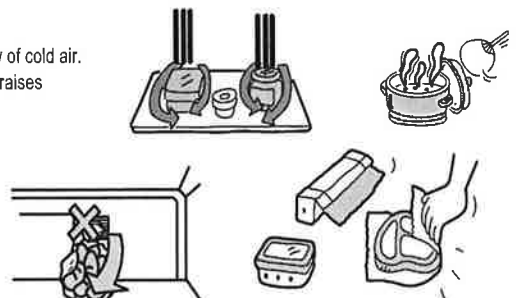

Operation

Identification Parts

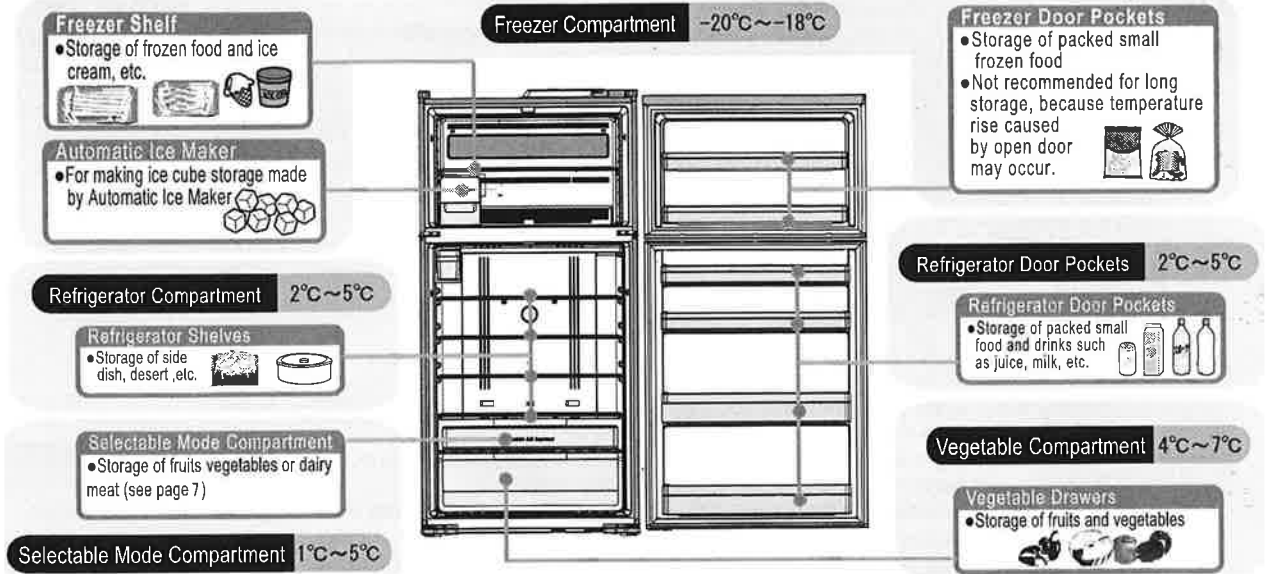

NOTE: Above temperatures are the approximate values at a condition of an out side temperature of 32°C , door being closed and without food storage.

Name and Function of display



Notice

- If you unplug the power plug or a power failure occurs and then the refrigerator restarts, the temperature display and each setting will be automatically resumed. However, "Quick Freezing" operation is cancelled.
- All display will be on 5 seconds after the power plug is inserted.

Cool Power Display

The display is indicating the operation status of the fridge by LED lighting scale. When the fridge is in high power operation, LED will flash more. However, the fridge operation will change based on usage, amount of foods, environment temperature, frequency of door open/close and temperature setting of each compartment.

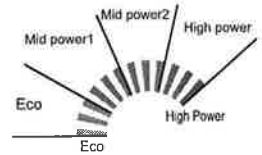

Clever Tips for the Cool Power Display usage.

- 1. Temperature setting**
If the temperature setting of each compartment is too cold, the fridge operation will change to High Power.
- 2. Door opening**
If frequently opening the door or leaving the door open for a long time, the fridge operation will change to High Power.
- 3. Food storage**
When storing too much food, blocking the air vent with food or storing hot food items the fridge, operation will change to High Power.

Temperature Control

The display is indicating the status of the temperature setting.

1. Freezer compartment

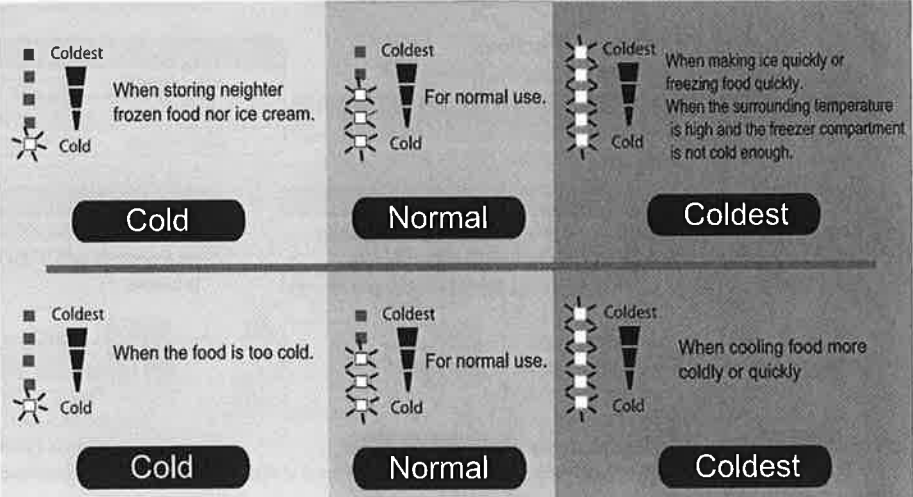
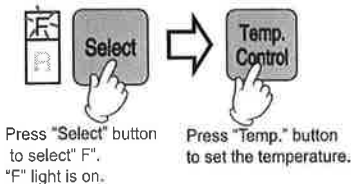

2. Refrigerator compartment

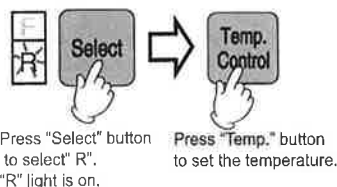

Operation

Other Functions

1. Quick Freezing

- When you want to freeze food or make ice quickly, use this function.

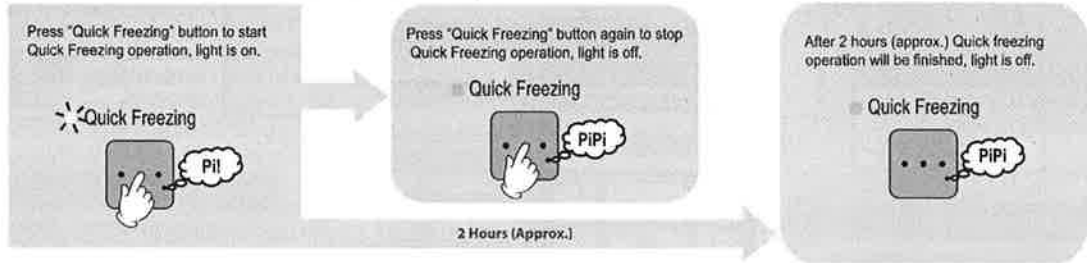

Notice

- During "Quick Freezing", priority cooling of the freezer compartment will be done. Thus, try to avoid unnecessary opening and closing of the doors to avoid a temperature rise of the refrigerator compartment.
- After "Quick Freezing" is automatically finished and if the button is pressed again, the lamp will turn on. However, the next "Quick Freezing" operation will not start. After 60 minutes, the operation will start.
- During defrost periods, even if "Quick Freezing" lamp is on, no operation will be made. After finishing the defrost operation, "Quick Freezing" will be automatically started.

2. Energy Saving

- Recommend to use this function in case of low storage volume, or a long vacation when the doors are not opened for long time.



Notice

- In case the compartment temperature rises up, the operation will be back to a normal setting temporarily.
- After a long time operation of "Energy Saving", in some cases, fatty ice cream, etc., may become soft. Please stop "Energy Saving" operation in this case.

Caution

- If "Energy Saving" operation is working in high humidity environment, dew may appear. Please stop "Energy Saving" operation in this case.

3. Child Lock

- You can prevent mischief of all the buttons on the control panel caused by children.



4. Door Alarm and ECO Alarm Functions

If the door is left open for more than 1 minute, the alarm system will inform the user by the sound and digital display.

- Door Alarm: Informs by Pipipi sound.
- Eco Alarm Display: Indicates the door opening state on the control panel.

Duration of Door Opening	Door Alarm Sound	ECO Alarm Display
After 1 minute	Pipipi	All LED on display are flashing
After 2 minute	Pipipipipi	
After 3 minute	Beeps continuously.	

To Deactivate Alarm and Sound

- Keep pressing "Select" button for 5 seconds until "Beep" sound is heard.

There is no sound when pressing any button (disactive door alarm sound).

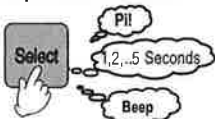

Notice

- Upon shipment, the alarm and sound are set "ON".
- Unplugging and inserting the power plug or in the event of a power failure the refrigerator will automatically reset the alarm to "ON".

To re-activate Alarm and Sound

- Keep pressing "Select" button for 5 seconds until "PiPi!" sound is heard.

There is sound when pressing any button (active door alarm sound).

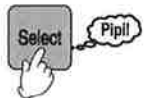
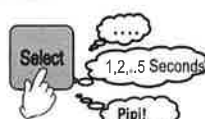

Operation

Freezer

Automatic Ice Maker

Turning on/off the Automatic Ice Maker Function

- After power on, the system will be set the Automatic Ice maker turn on every time
- Press Quick freezing button and hold for 5 seconds for turn on/off the Automatic Ice Maker (Press again Ice maker light will be turn off and the Automatic Ice maker will be stop with sound "PIPI")

Ice Maker (Press 5 Sec.)
Quick Freezing

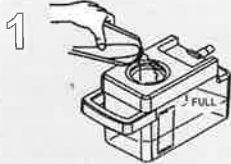

1 Filling the pure water until the "FULL" level then closed by cap.

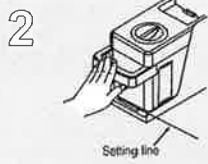

2 Push the tank into the case until it locked at the setting line.

Caution

Using the ice maker for the first time :

- Throw away the first full ice box of Ice cubes. Odor or dust may adhere on it.
- If water tank was dropped, make sure that water is not leaking from the tank.
- Do not fill other liquid, any beverages such as juice, Coke beer etc, into the water tank.
- Do not fill hot water into the tank (Tank Heat-resistance temperature : 50 °C)
- Do not put anything, such as frozen food, ice cream other than ice in the ice box,
- Do not touch ice lever detector or ice tray with your hands, You may injured.

Notice

- For a first installed, Allow 24 hours for the refrigerator cool down and make ice.
- Ice maker will stopped automatically when Ice box is full and it will started again automatically when ice cubes in the ice box is reducing or empty.
- It is normal that a noise is generated when Ice made or Ice dropped into the ice box.

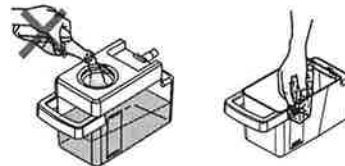
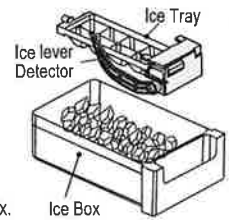

Cleaning the Water Tank

Notice

- Both water tanks (Water dispenser and Ice maker) should be cleaned every week for reasons of hygiene.
- Using a clean sponge or soft cloth and a mild detergent in warm water, hand wash, rinse and dry all removable parts and interior surfaces thoroughly.

Refrigerator

1. Selectable Mode Compartment

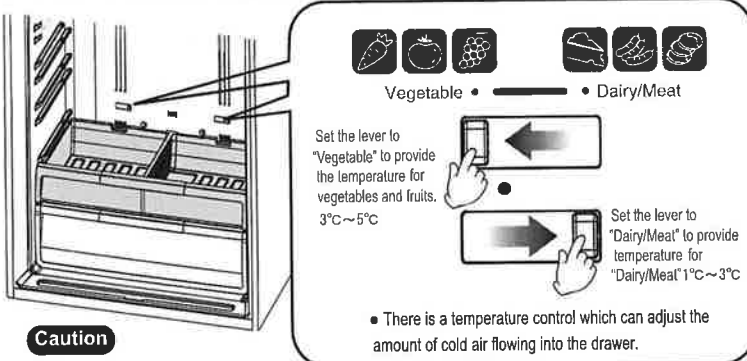

Caution

- If you want to store meat or fish longer, please store them in the freezer compartment.
- Be careful, it might be frozen if that food has a lot of moisture.
- When closing the refrigerator door, push the chilled case to close. If you close the door while the chilled case is still pulled out, the chilled case might be broken.
- Meat and fish can be kept fresh before being frozen.

2. Egg Pocket

- You can place 14 eggs and also turn the rear side to place small items.

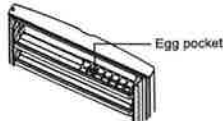

3. Adjusting the Shelves

- Pull up the front and pull out the shelf forward.
- Set the refrigerator shelves by combining with stored food.



4. Adjusting the Drawer Divider

- The Drawer Divider can be adjusted by moving it left or right. It can also be removed when you need more space to keep some big items.

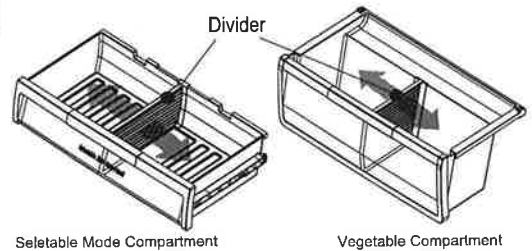

Selectable Mode Compartment

Vegetable Compartment



The drawer is large enough for children or pets to crawl inside. DO NOT allow them to play inside the drawer.

Cleaning

Cleaning (Please clean the refrigerator once a month)

- Unplug the refrigerator.
- Remove all food.
- Wipe the refrigerator clean.
 - It is the best if smudges are wiped off immediately. It is also recommended to clean the areas of the refrigerator not clearly in view once a year.
 - Use a soft cloth moistened with lukewarm water to wipe of smudges. For smudges which are difficult to remove, use a diluted cloth.
 - Neatly clean the door gasket because it gets dirty easily.
- If any droplets remain on the surface of the parts that have been washed, wipe them.
- Return all parts their original locations.

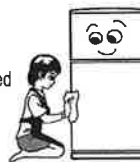

6. Inspect and clean the power plug, cord and outlet.

7. Plug the power cord into the outlet.

Notice

- Even if the power plug is plugged in immediately after being unplugged, the compressor will not run for 10 minutes. However, if the inside is not cold, it will start running in approximately 30 seconds.
- If the cooking oil smears on the refrigerator, please wipe it off. (The plastic parts might be cracked).

Caution

- Do not use the following items which damage parts and painting : Polishing powder, soap powder, oil, boiling water, brush, acid, benzene, thinner, alcohol and alkaline detergent, etc.

Malfunction Display

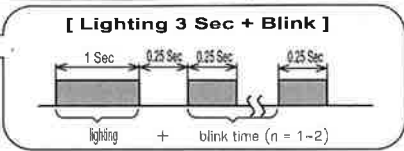
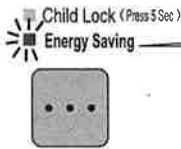

Error Trouble Display	Possible cause	What to check
Light 3 sec. Blink once	<ul style="list-style-type: none"> The freezer compartment door could be touching some food or other object and might not be closed properly. 	<ul style="list-style-type: none"> Remove the obstacles if any, and confirm that the freezer compartment door is closed properly. Then, wait for the inside of the freezer compartment to cool sufficiently.
Light 3 sec. Blink twice	<ul style="list-style-type: none"> The refrigerator compartment door could be touching some food or other object and might not be closed properly. 	<ul style="list-style-type: none"> Remove the obstacles if any, and confirm that the refrigerator compartment door is closed properly. Then, wait for the inside of the refrigerator compartment to cool sufficiently.



Before Requiring Repair (Calling for Service).

Before you call for service, please check the following items.

The refrigerator does not get cold at all.	<ul style="list-style-type: none"> Is the refrigerator plugged in properly? Check the fuse box for blown fuse or tripped circuit breaker. 	
The refrigerator does not get cold enough.	<ul style="list-style-type: none"> Is the refrigerator placed in the direct sunlight? Is the refrigerator placed near a heat source? Is the temperature control dial set to "COOL"? Has anything hot been placed in the refrigerator? Is the food stored too much? Is the door being opened and closed too frequently? Is the door being slightly open? 	
Food in the refrigerator compartment freezes.	<ul style="list-style-type: none"> Is the temperature control dial set to "coldest"? Do you place the high moisture food and vegetables at the inner part of the shelf nearby the cold air vent? They will be frozen if being placed nearby the cold air vent. 	
Dew appears.	Outside	<ul style="list-style-type: none"> When the high humidity outside and door gasket have dew, please wipe it up by dry cloth.
	Inside	Please wipe it up with dry cloth and please check the details below. <ul style="list-style-type: none"> Is the door closed firmly? Is the door being opened and closed too frequently or opened for a long time? Is there high humidity?
The inside is smelling.	<ul style="list-style-type: none"> Do you store odor food without wrapping it? 	
Sound is noisy.	<ul style="list-style-type: none"> Make sure the refrigerator is installed firmly. Is the refrigerator touching the wall? 	
Frost forms on the wall of the freezer room	<ul style="list-style-type: none"> Did you make too many ice cubes in the freezer room? Condensation can occur when you leave the door open for a long time. Then it frost forms on the wall. 	



This is not out of order.

The surface of the refrigerator is hot.	<ul style="list-style-type: none"> The refrigerator contains the dew prevention and heat radiation pipes. Especially the back may be heated when starting up or if the door is frequently opened and closed.
If a door is shut, other doors may open.	<ul style="list-style-type: none"> The air duct of two compartment is connected. When close one of the door, another door may be opened by the wind pressure. This is a normal phenomenon.
Does it have any abnormal sound?	<ul style="list-style-type: none"> The sounds like water flowing and boiling water are sound of the cooling liquid (refrigerant). A creaking sound comes from the storage compartment. It is the sound caused by friction of the parts due to temperature change.

Service Center

- When you request repair, please check the refrigerator well according to page number 8. When still abnormal, be sure to contact the retailer of purchase or the following service center after pulling out a power supply plug.

Service Center	TEL No.
Hitachi Sales (Thailand), Ltd. 994, 996 Soi Thonglor, Sukhumvit 55 Rd., Klongtonnua, Vadhana, Bangkok 10110	• 0-2335-5455

- Telephone numbers are subject to change without notice.